

INFORMATION ONLY

Directions for Problems 2-59 through 2-70:

Construct one-view drawings of the following figures using existing AutoCAD commands.

Problem 2-59

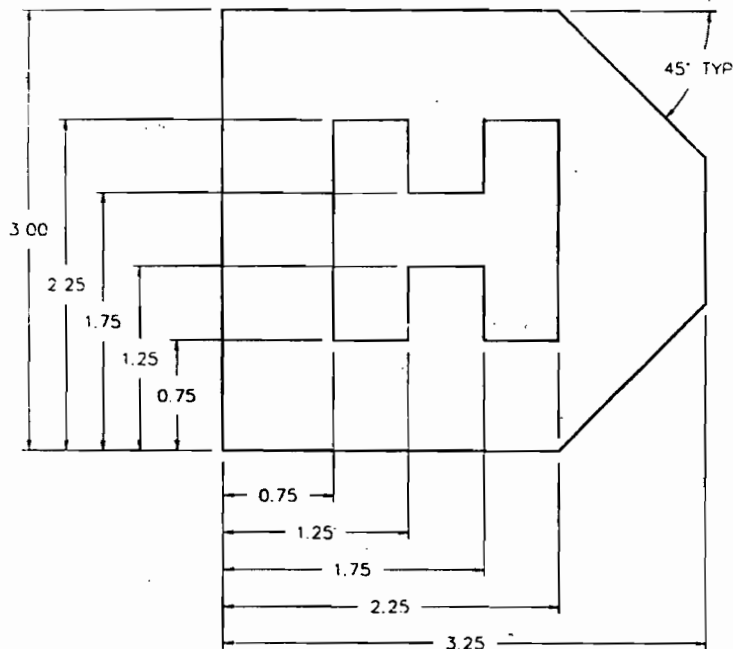

Problem 2-60

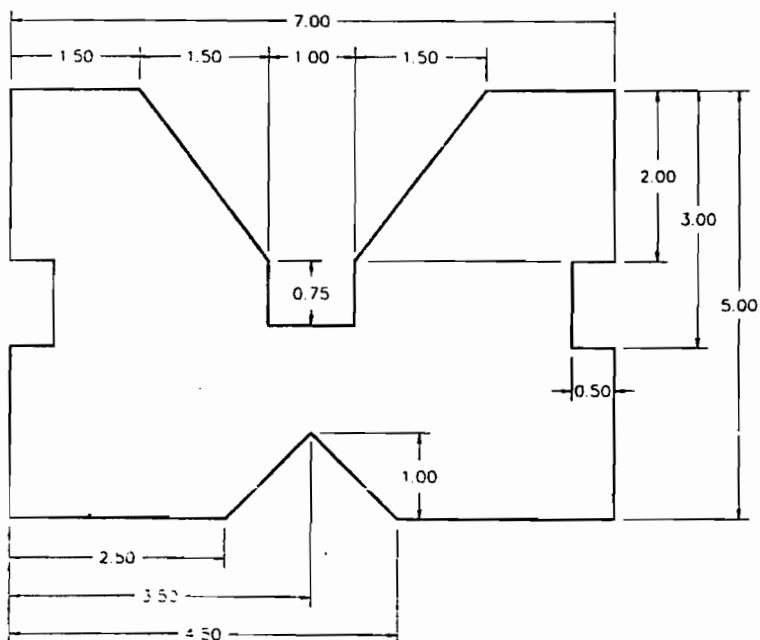

Problem 2-61

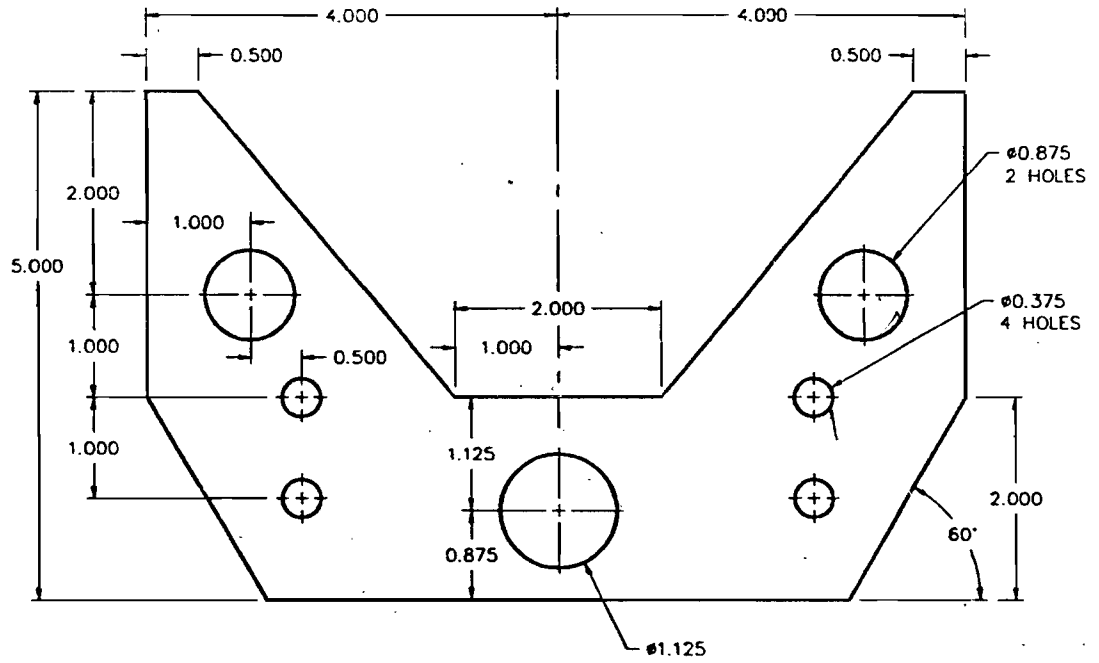

Problem 2-62

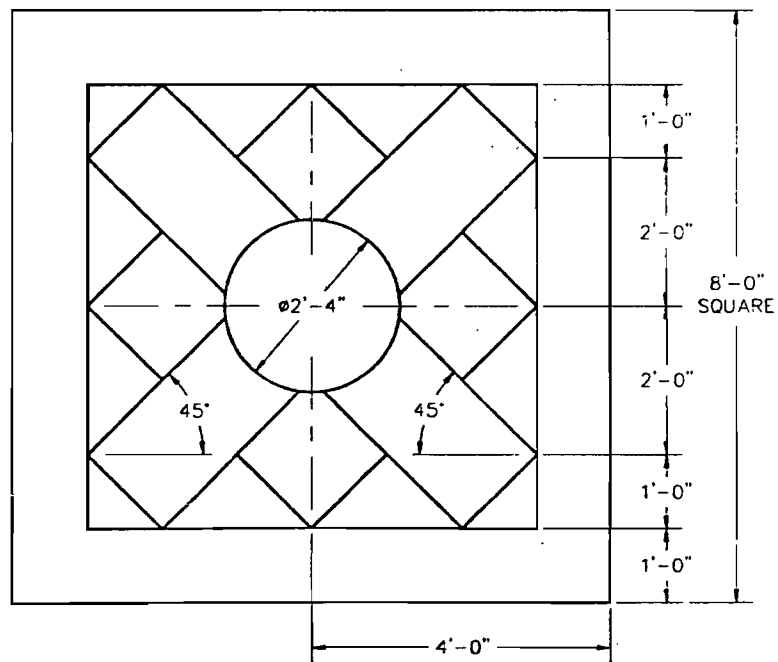

Problem 2-63

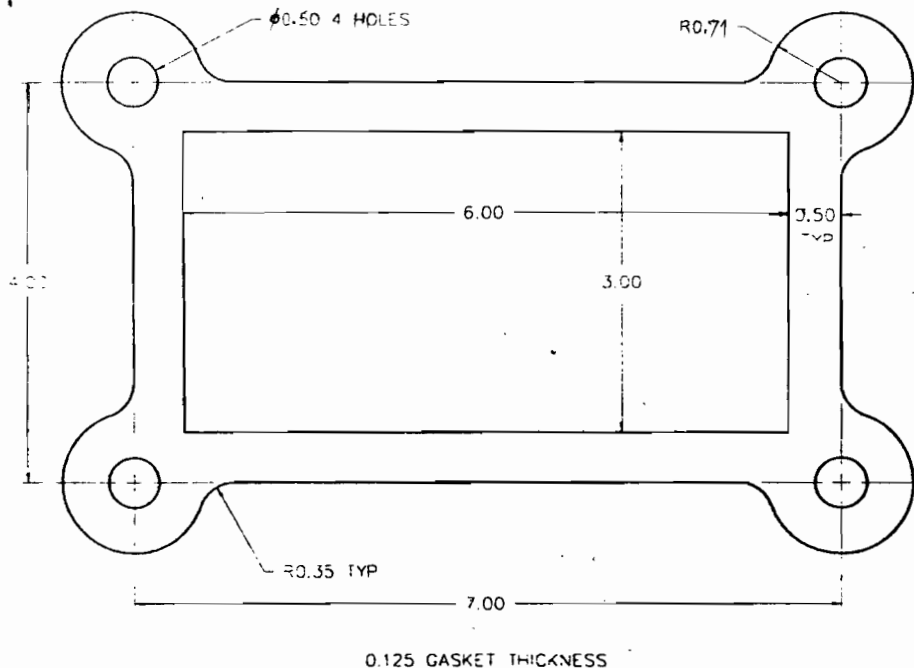

Problem 2-64

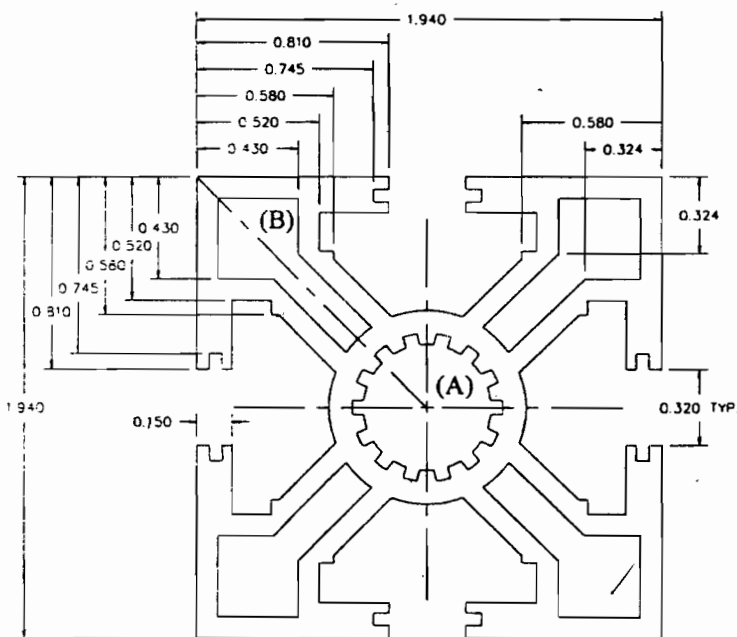

$1.94/2 = 0.97$
 $0.025/2 = 0.0125$

Area "A"

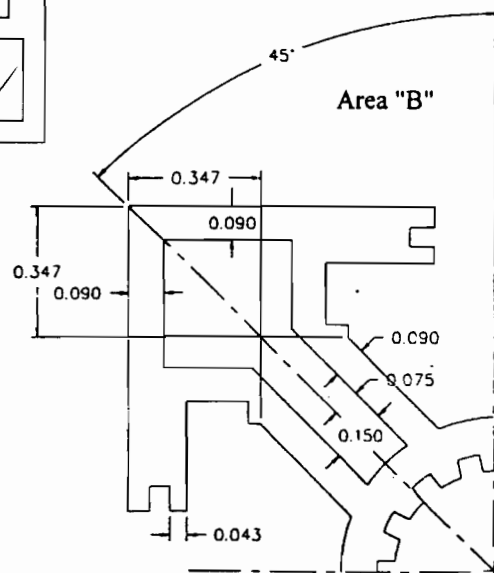
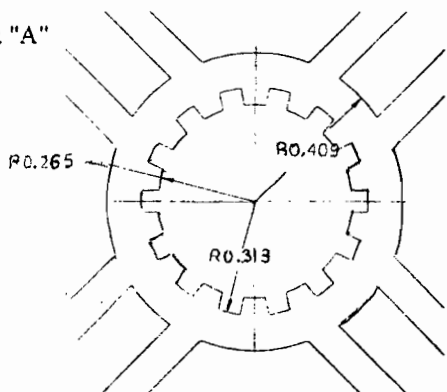

Problem 2-65

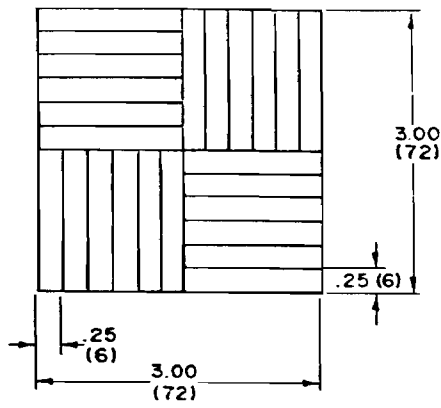

Problem 2-68

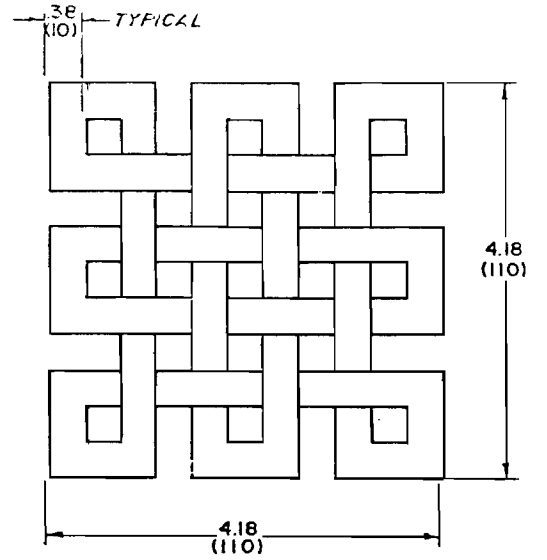

Problem 2-66

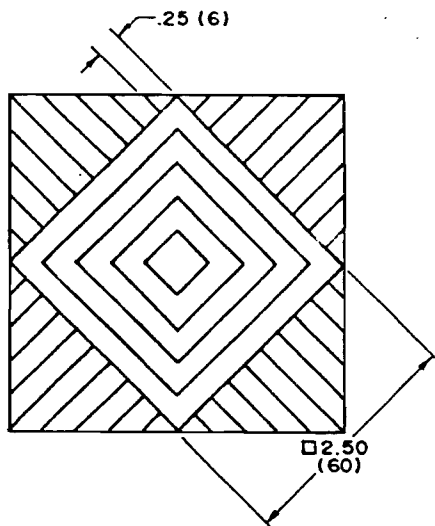

Problem 2-69

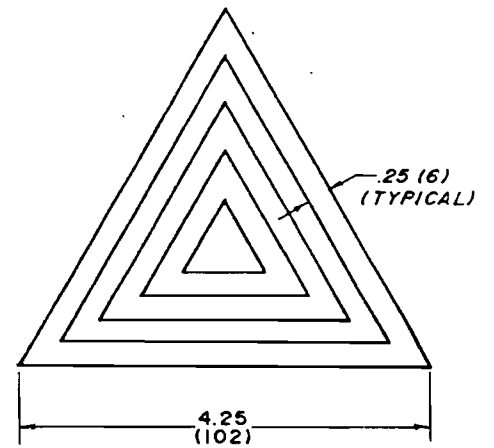

Problem 2-67

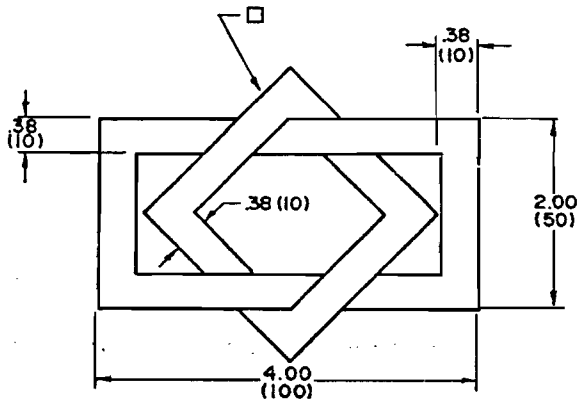

Problem 2-70

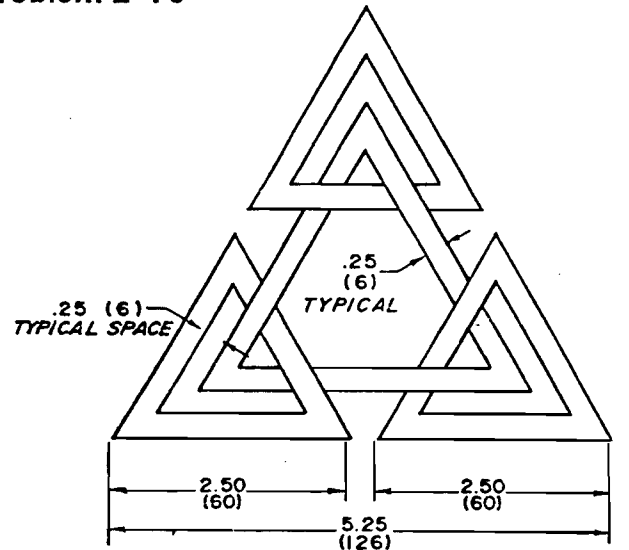

Directions for Problems 2-71 through 2-74:

Construct one-view drawings of the following figures using a grid spacing of 0.25 units. Do not dimension these drawings unless otherwise specified by your instructor.

Problem 2-71

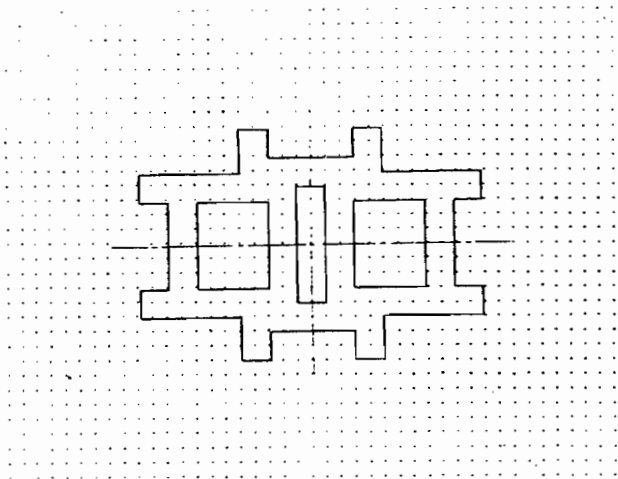

Problem 2-73

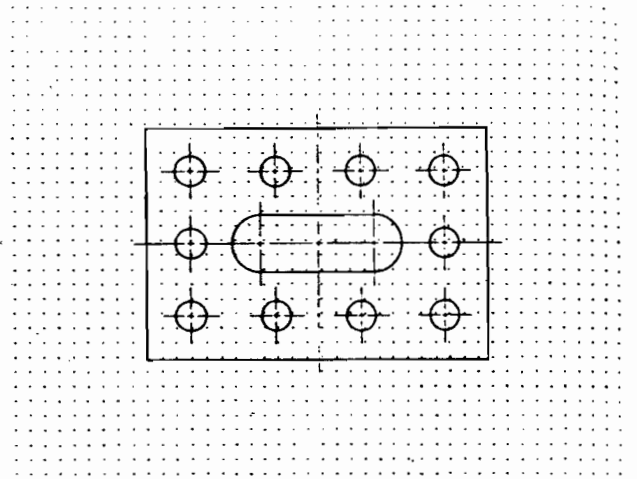

Problem 2-72

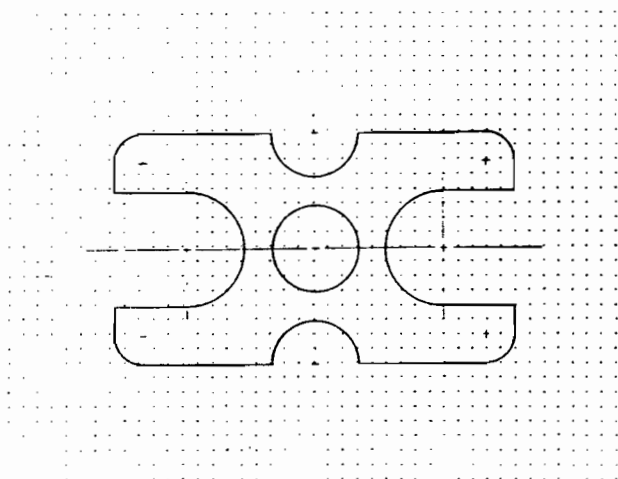

Problem 2-74

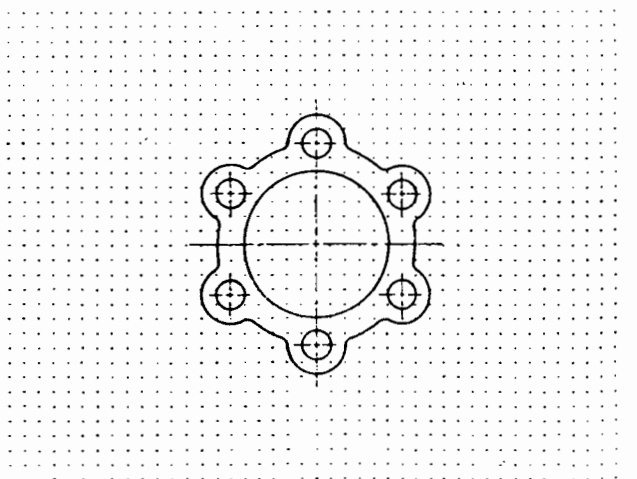

Problems for Unit 3

Directions for Problems 3-1 through 3-21:

Construct these geometric construction figures using existing AutoCAD commands.

Problem 3-1

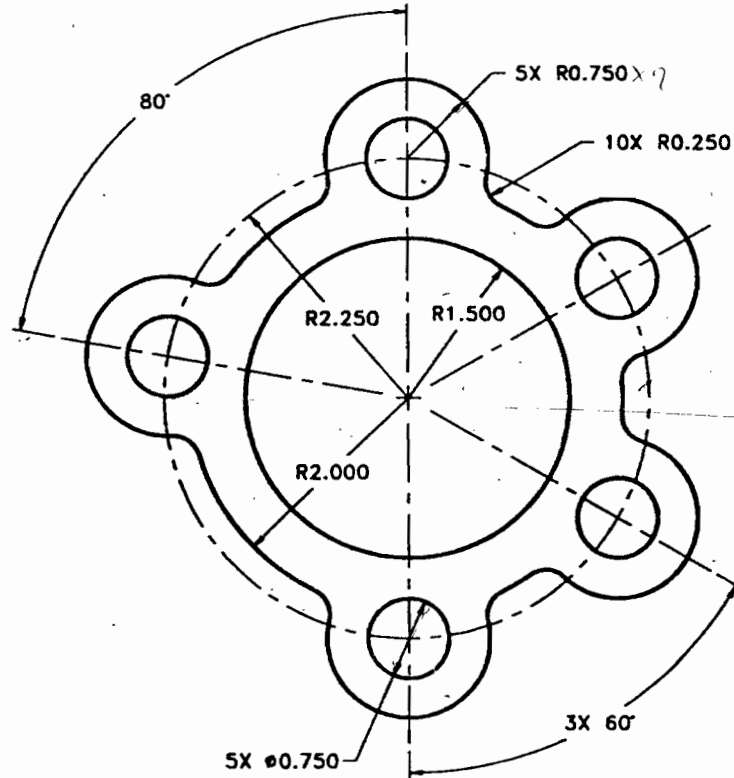

Problem 3-2

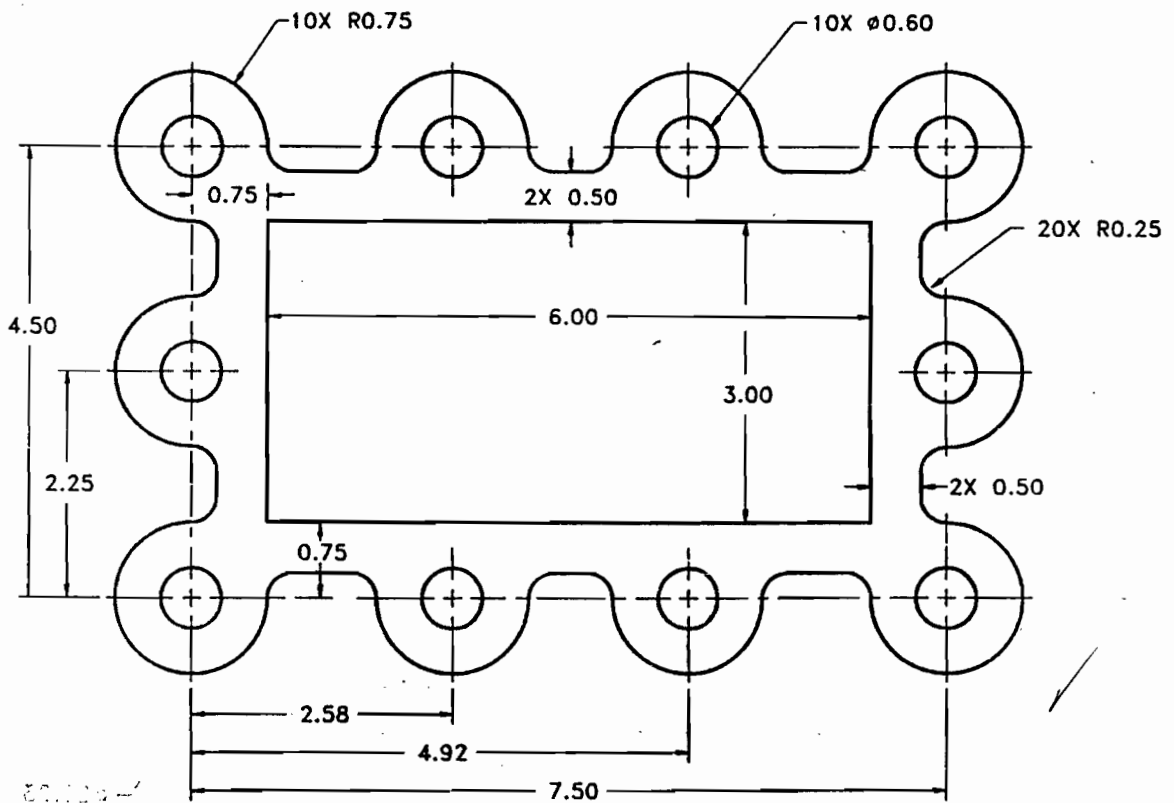

Problem 3-3

0.1875

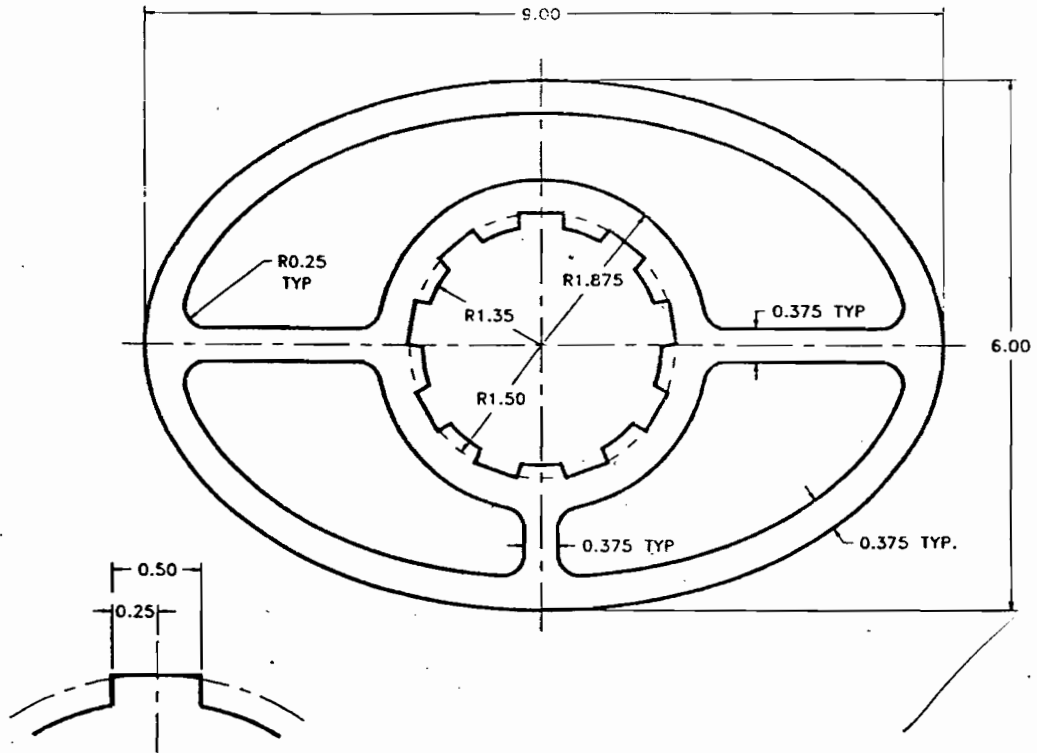

Problem 3-4

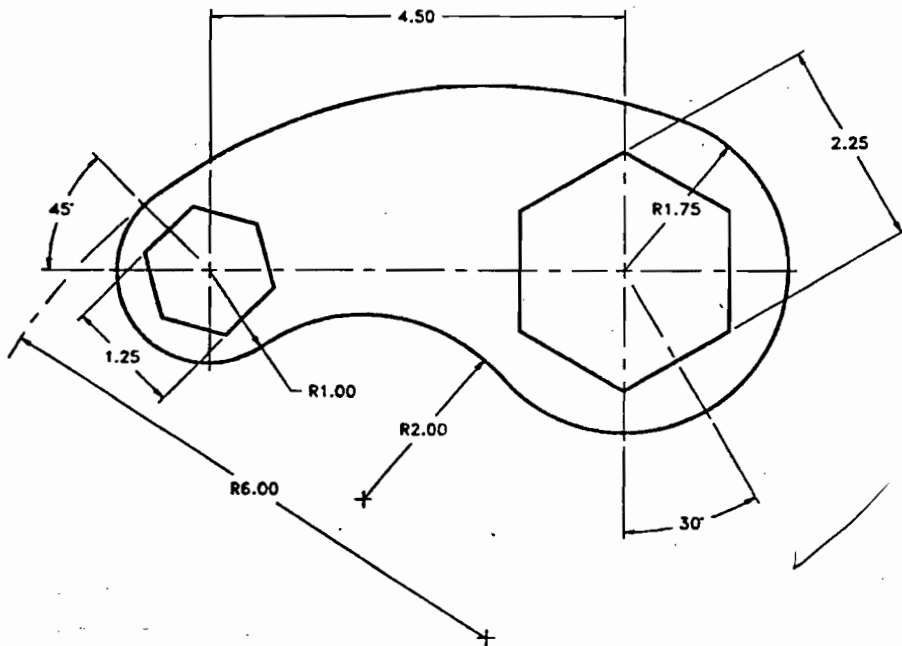

Problem 3-5

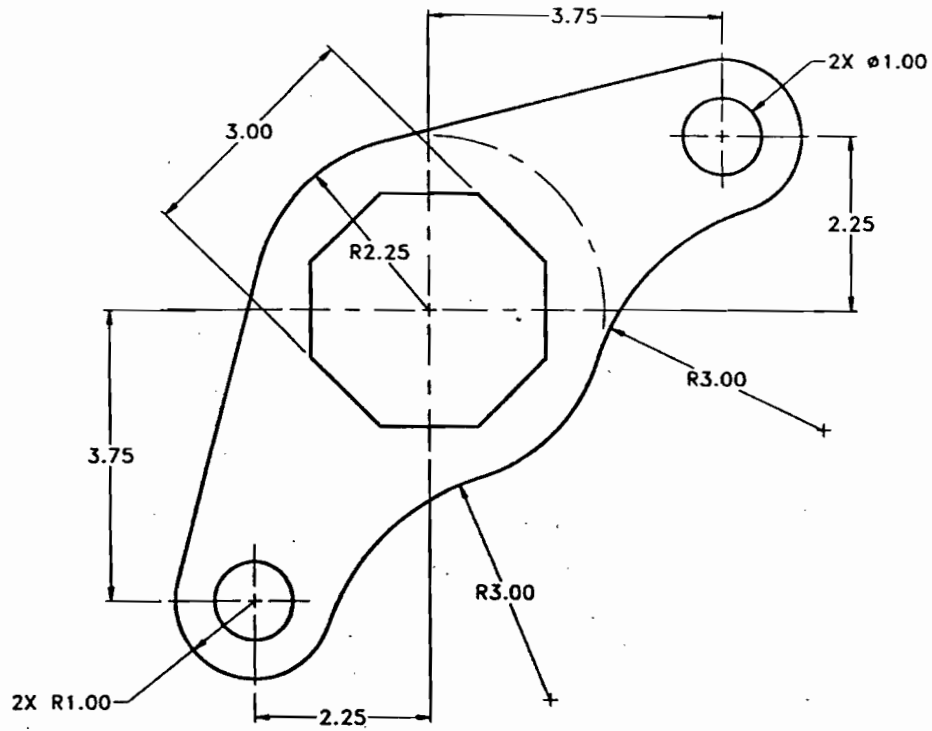

Problem 3-6

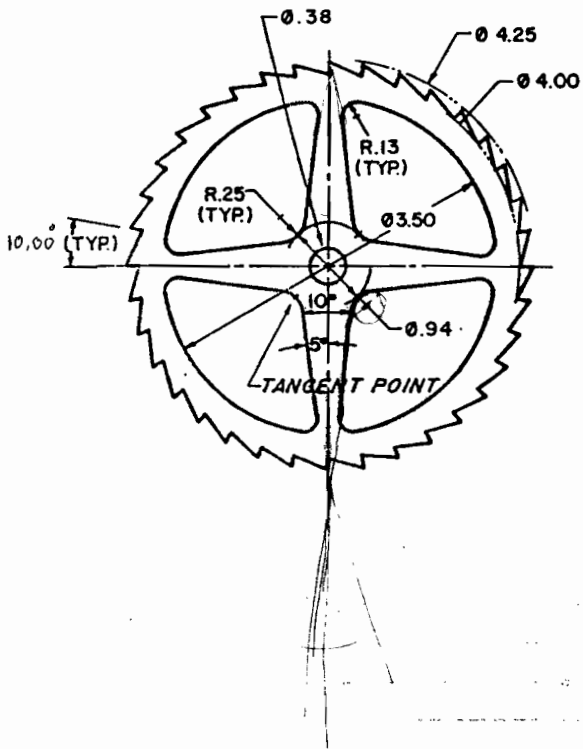

Problem 3-7

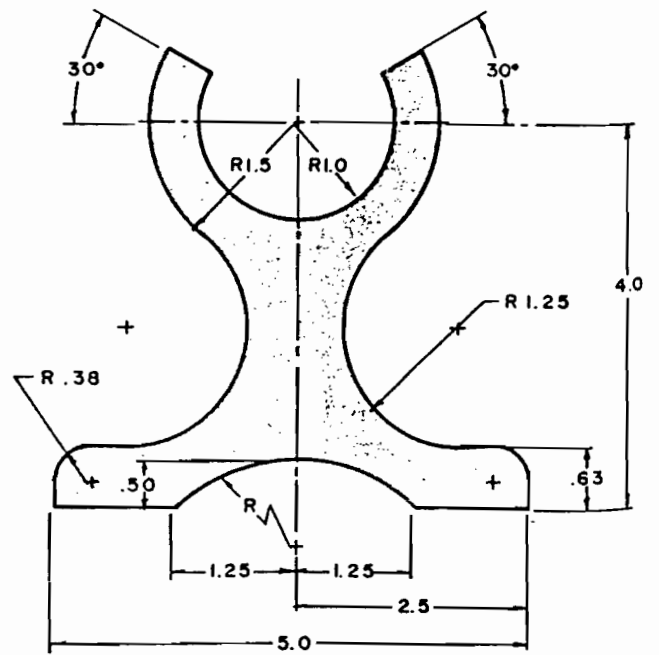

Problem 3-8

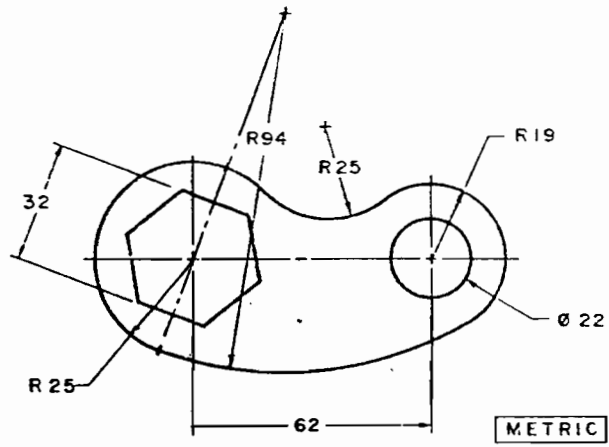

Problem 3-9

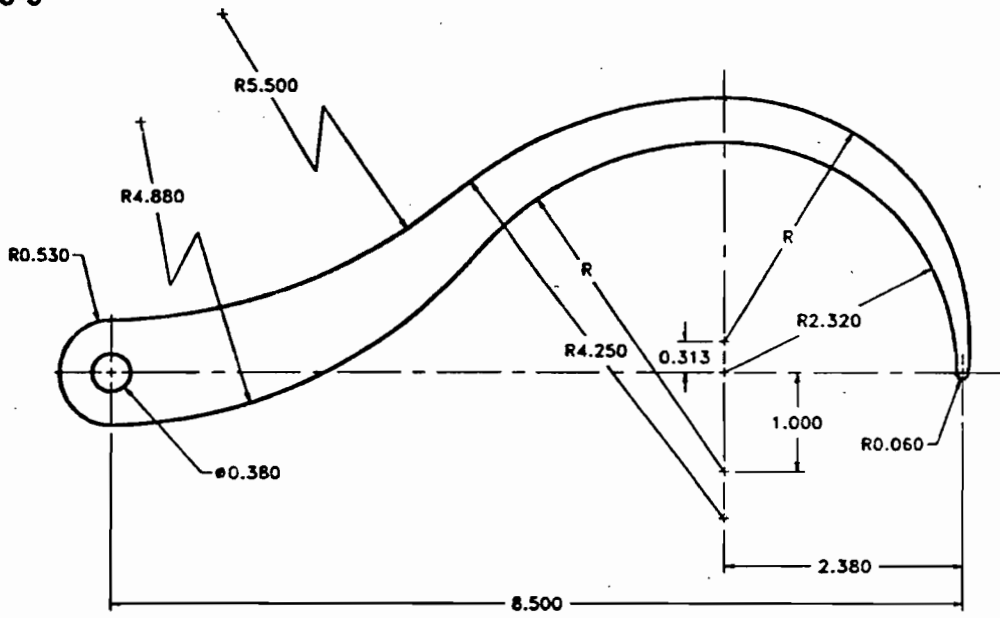

Problem 3-10

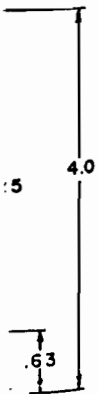
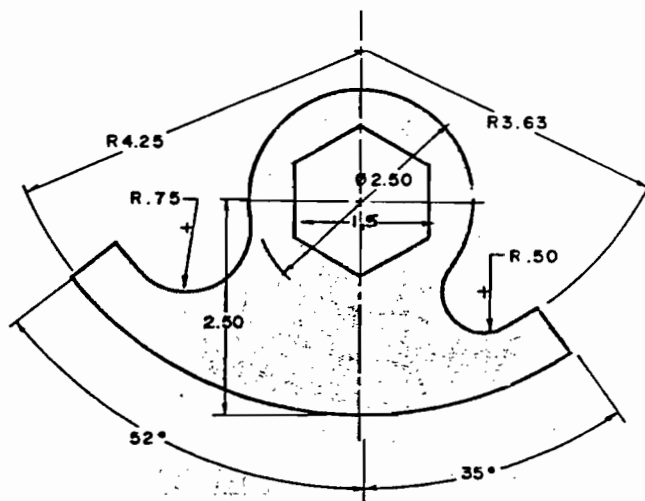

Problem 3-11

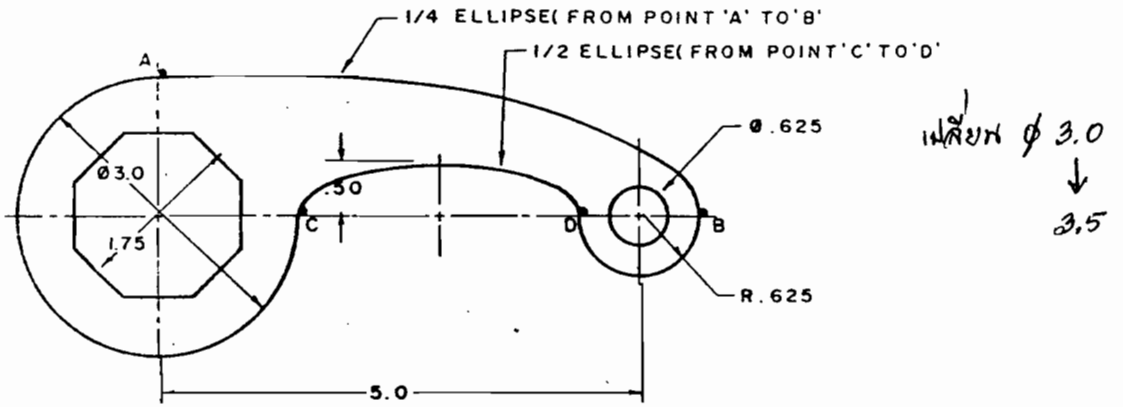

Problem 3-12

Problem 3-13

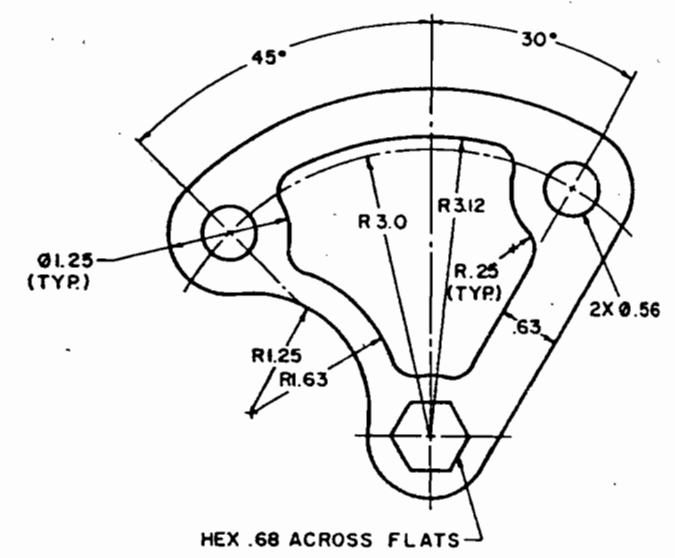
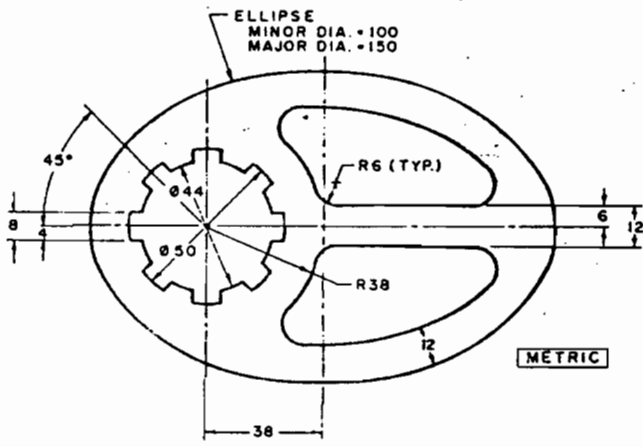

Problem 3-14

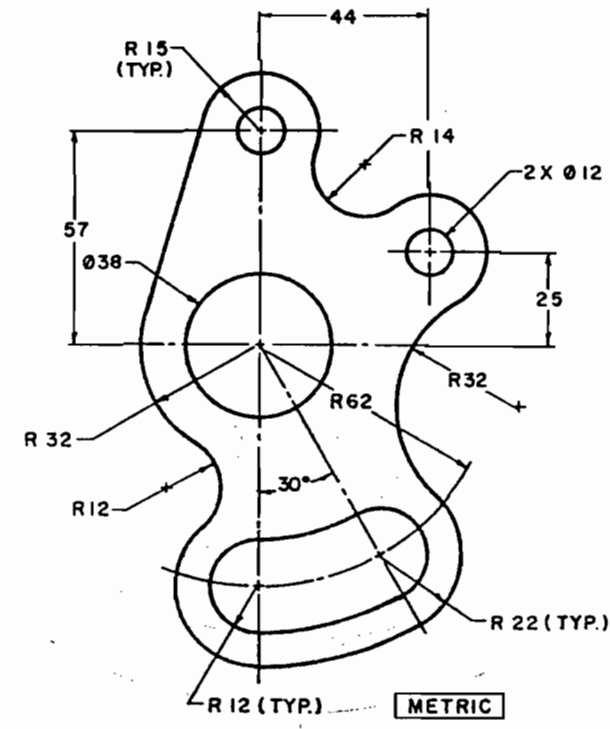

Geom
Prob

Prob

ELLIPSE
61.38 M
81.75 M

38
76
T

R

Problem 3-15

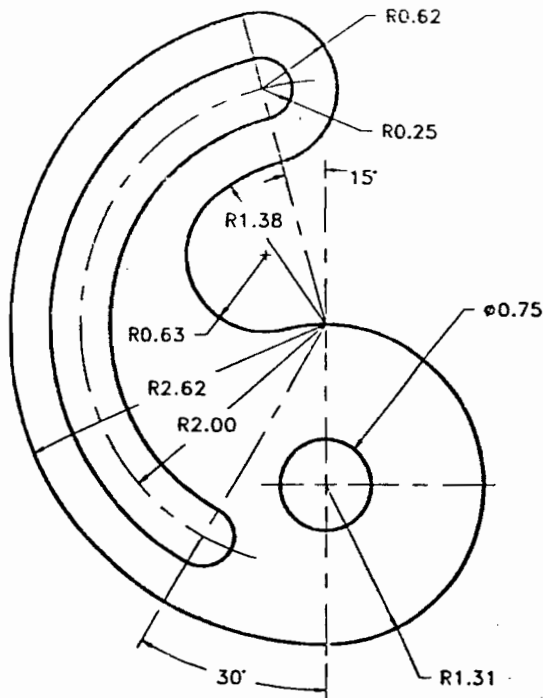

Problem 3-17

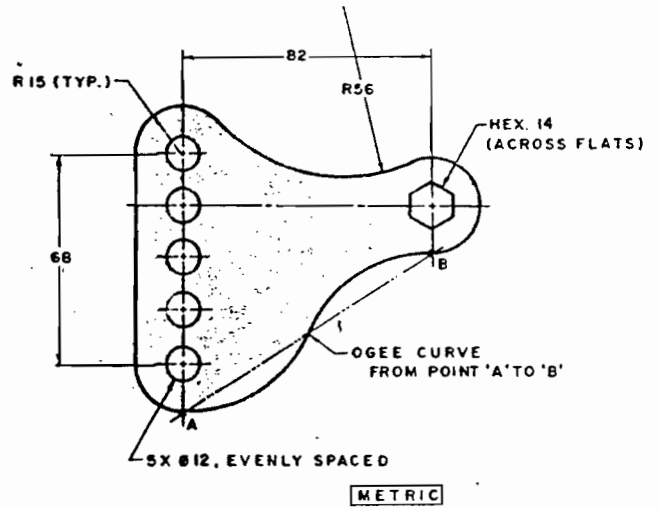

Problem 3-16

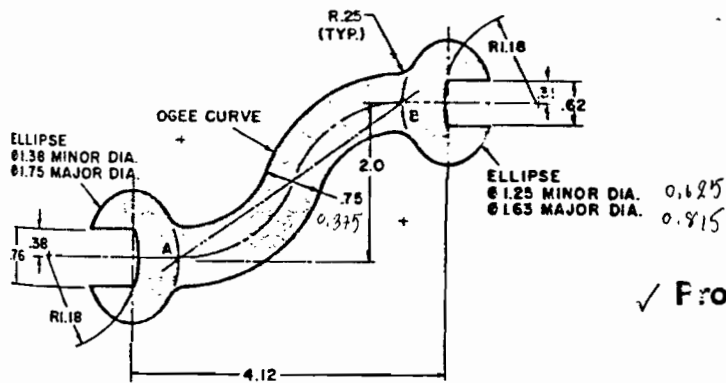

0.69
 0.875
 1.11
 2.36

Problem 3-18

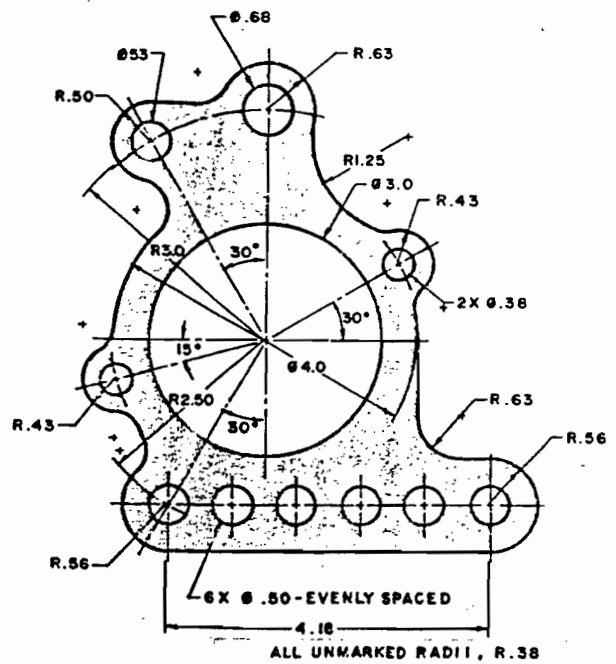

Problem 3-19

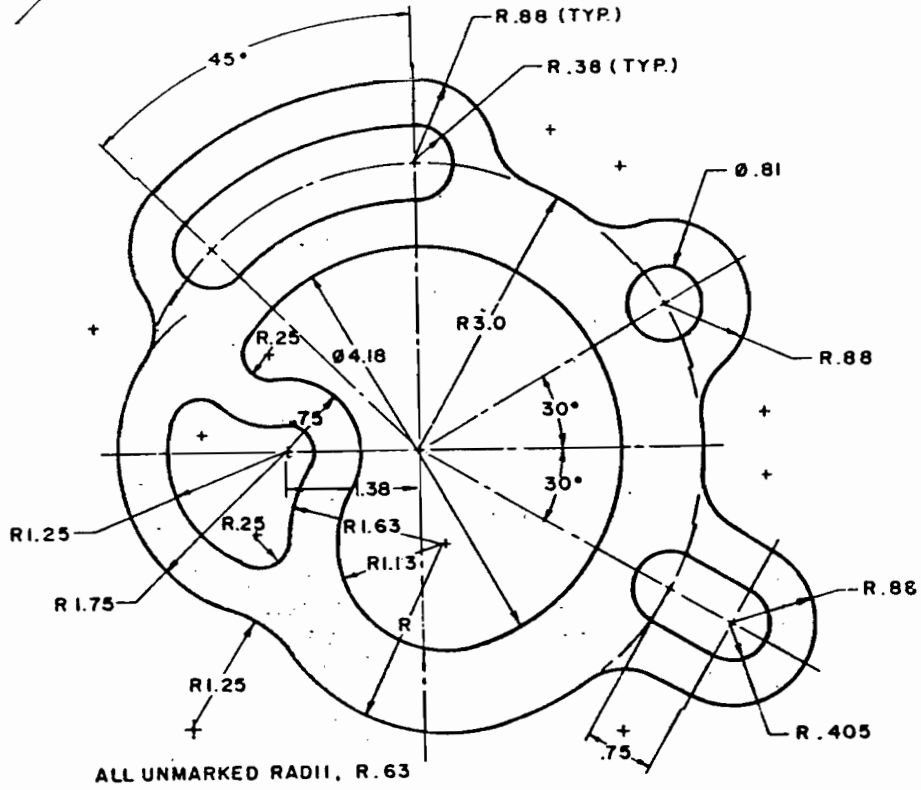

Problem 3-20

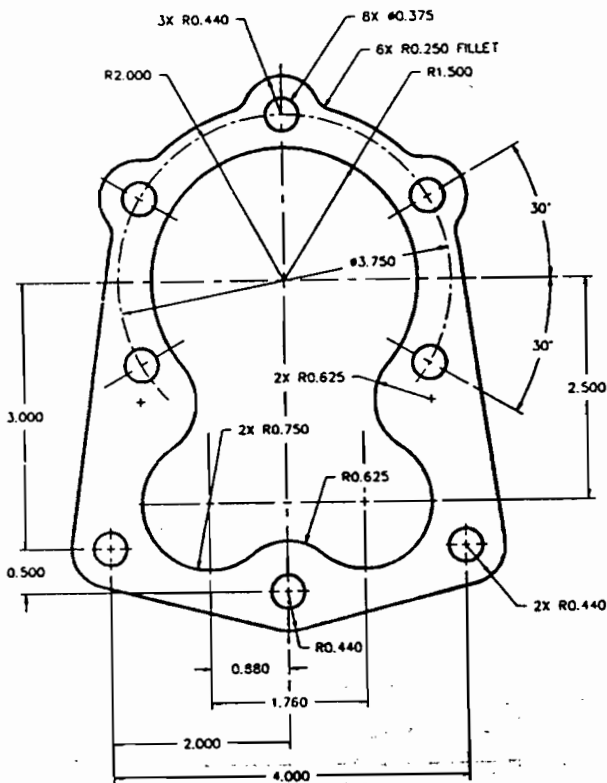

Problem 3-21

